

Job Name: _____	Client Name: _____
Job Location - City: _____ State: _____	Created By: _____ Date: _____
Product: _____ Quote: _____	Customer Approval: _____ Date: _____

SPECIFICATIONS

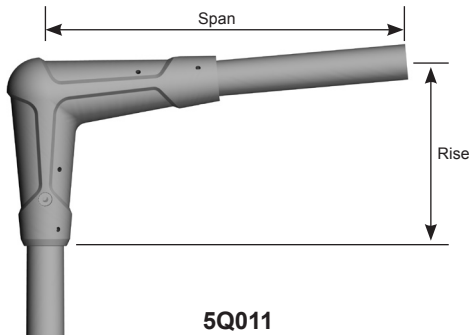

5Q011

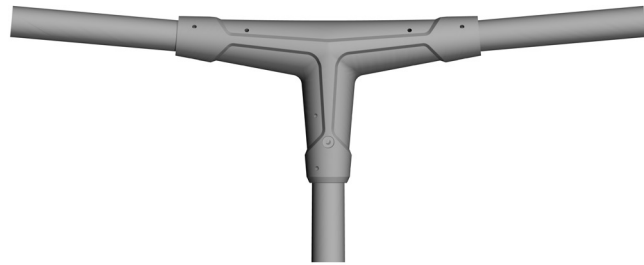

5Q012

LOAD AND DIMENSIONAL DATA

DESIGN INFORMATION							LOADING INFORMATION		
ARM DESIGN	MODEL NUMBER	ARM TYPE	SPAN (FT)	RISE (IN)	ARM EPA (SQ FT)	ARM WEIGHT (LBS)	MAX DESIGN WIND SPEED (MPH) w/ 1.3 GUST	MAX LUMINAIRE EPA (SQ FT)	MAX LUMINAIRE WEIGHT (LBS)
Single	5Q011	A01	1.5	11.75	1.01	10	100	3.00	75
		A02	2	12.28	1.10	11	100	3.00	75
		A03	3	13.33	1.33	12	100	3.00	75
		A04	4	14.38	1.54	13	100	3.00	75
		A06	6	16.48	1.98	16	100	3.00	75
		A08	8	18.58	2.42	22	100	3.00	75
Double - 180°	5Q012	A01	1.5	11.75	1.14	14	100	3.00	75
		A02	2	12.28	1.33	16	100	3.00	75
		A03	3	13.33	1.77	18	100	3.00	75
		A04	4	14.38	2.21	21	100	3.00	75
		A06	6	16.48	3.08	26	100	3.00	75
		A08	8	18.58	3.96	38	100	3.00	75

NOTE:

- Two-piece construction consisting of a cast aluminum hub and aluminum pipe arm
- Choice of six arm-spans for optimal illumination to match a variety of roadway settings
- Cast aluminum hub accepts 2.38" OD X 6.00" tall pole top tenon or 2.40" OD pole top

PRODUCT ORDERING CODES

DESIGN SERIES	MODEL NUMBER	ARM TYPE	LUMINAIRE MOUNTING	LUMINAIRE ARM COLOR		OPTIONS
PTA	5Q011 5Q012	A01 A02 A03 A04 A06 A08	E2 = 2.38" OD Slip Fit	STEEL WH = White ST = Sandstone BK = Black SM = Silver Metallic SL = Silver LG = Light Gray SG = Slate Gray DT = Dark Tan MB = Medium Bronze CB = Bronze DB = Dark Bronze BN = Brown HG = Hunter Green DG = Dark Green RD = Red SC = Special Color (Contact Factory)	ALUMINUM DWH = White DSS = Sandstone BR = Burgundy HG = Hunter Green DNA = Natural Aluminum DCG = Charcoal Gray DMB = Medium Bronze SBN = Sanded Brown DNB = New Dark Bronze DDB = Dark Bronze SBK = Sanded Black DBL = Black DSB = Steel Blue DTG = Dark Green DBR = Red SC = Special Color (Contact Factory)	See Accessories at valmontstructures.com (Please Specify)