

**CONTROL GEAR CLEARANCES**  
1:10

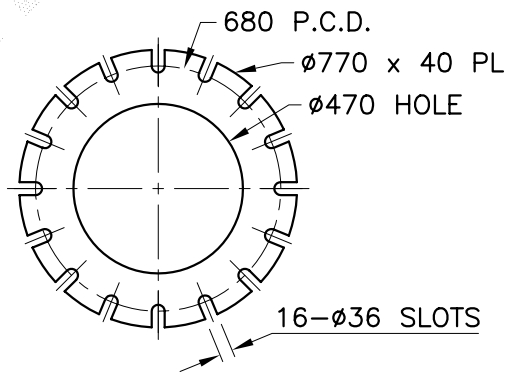

**VIEW A**  
SCALE 1:20  
BASEPLATE FOR 16- M30 RAGBOLTS

**NOTES:**

1. ALL STEEL COIL TO CONFORM TO AS/NZS 1594 GRADE HU300 U.O.N.  
ALL STEEL PLATES TO CONFORM TO AS/NZS 3678 GRADE 250 U.O.N.
2. ALL STEEL BARS AND SECTIONS TO CONFORM TO AS/NZS 3679 GRADE 250 U.O.N.
3. ALL WELDS TO CONFORM TO AS/NZS 1554 PART 1
4. ALL TAPER LOCK JOINT LENGTHS ARE NOMINAL U.O.N.
5. ALL STEEL TO BE FULLY HOT DIP GALVANIZED AFTER FABRICATION  
IN ACCORDANCE WITH AS/NZS 4680

REV	DATE	DESCRIPTION	BY	CHKD
2	6/11/03	DOOR MOUNTING DETAILS CHANGED	P.B.	FPM
1	14/12/99	MOUNTING DETAILS CHANGED	I.W.	FPM
0	15/4/99	FIRST ISSUE	I.W.	CS

CUSTOMER/PROJECT

COPYRIGHT  
THIS DOCUMENT PRODUCED  
BY INGAL EPS MUST NOT  
BE COPIED, TRACED,  
REPRODUCED, OR LENT  
WITHOUT WRITTEN CONSENT

DIMENSIONS IN MILLIMETRES



DO NOT SCALE

CHECKED BY DATE 21/6/99

**INGAL EPS**

FLOODLIGHTING  
27m MEDIUM DUTY PARK RANGE  
BASEPLATE MOUNTED  
RIVERTON DESIGN

CATALOGUE NUMBER  
FPM27F  
DRAWING NUMBER  
FPM27F

DATE 15/4/99

DRAWN BY I. WHITE

SCALE 1:125

CAD FILE No. Z:\ACAD\STD\PARK\FPM27F