



OVERVIEW

A utility pole (or a tree) offers no energy absorption during a head on impact; consequently the occupants and vehicle will absorb all the impact energy being released from a vehicle decelerating to a halt in a fraction of a second. The consequences are quite obvious.

Approximately 30% of the run-off-road fatalities involve severe impacts with hard objects such as poles and trees. The cost of removing these hazards can be prohibitive as it may involve re-layout of the road itself; as a consequence these hazards are often left unattended until a serious accident occurs.



The **RAPTOR™** is an energy absorbing device designed to reduce the severity of vehicle impacting with utility poles or trees. Its unique technology offers a compact low cost solution in places where typical crash cushions would not physically fit.

RAPTOR™ offers exceptional vehicle control and energy absorbing capabilities during head on collisions; the impact energy is absorbed by internal plastic cartridges. **RAPTOR™** is also capable of deflecting a vehicle in side-on angled impacts.

The **RAPTOR™** system has been tested to both MASH and NCHRP 350 guidelines for a gating, non-re-directive crash cushion and has been judged to have satisfied the required evaluation criteria for Test Level 1 (TL-1).



2000kg Pick-up truck impacting head-on with a pole using the RAPTOR™ at 50kph

FEATURES

- Highly reduces the severity of vehicle impacts against poles and trees
- Meets both MASH TL1 and NCHRP 350 TL1 test criteria
- Usable in places typically impossible to protect
- Compact size and easy installation (under 30 minutes)
- Two sizes available to fit multiple width hazards
- Zero maintenance, UV Stabilised, expected lifespan 25 years
- Smooth surfaces and geometry, suitable for vulnerable road users
- After a collision occurs, the non-impacted side can still be re-used
- No foundations are required
- Fully recyclable very low cost protection



RAPTOR™ 300 - Overall Dimensions

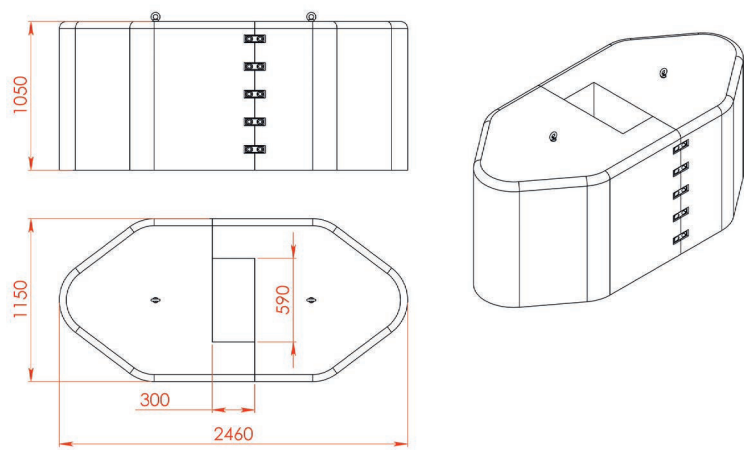

SPECIFICATIONS

Specifications	
Overall Length	2460mm
Height	1050mm
Width	1150mm
Void Size	300mm x 590mm
Shells & Cartridges	Stabilised PE (UV8)
Connector & Fixings	Galvanised Steel
Weight (per shell)	110kg

RAPTOR™ 600 - Overall Dimensions

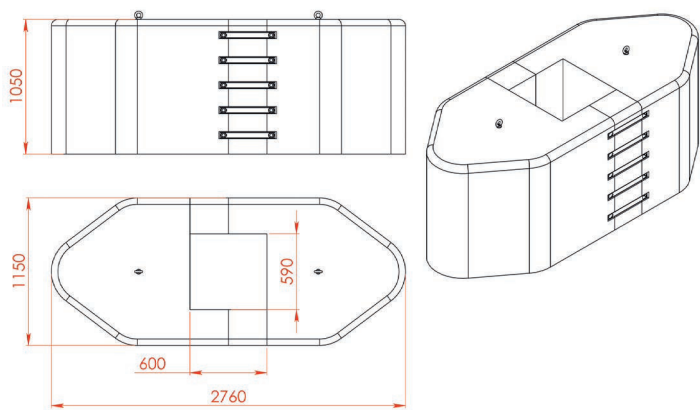

Specifications	
Overall Length	2760mm
Height	1050mm
Width	1150mm
Void Size	600mm x 590mm
Shells & Cartridges	Stabilised PE (UV8)
Connector & Fixings	Galvanised Steel
Weight (per shell)	110kg
Weight (per packet)	12kg



SUMMARY

The **RAPTOR™** is a safety device purposely aimed to reduce the impact severity of errant vehicles with a utility pole or tree. It has been designed, tested and accepted to both MASH and NCHRP 350 TL1 criteria.

Its exceptional vehicular control and energy absorbing capabilities during end-on impacts makes the **RAPTOR™** an ideal solution for utility pole or tree protection.

Due to its simplistic design, installation and repairs can be done under 30 minutes, promptly reestablishing the safety on our roads.



AM(v8) 241012

REPRESENTED BY:

